



Frances Brown
Pittsford, Maine



The land along the river is alluvial meadow, and most of the town is underlaid by limestone. The village lies upon a terrace about twenty feet above the river on a level plain a mile in length. In its rear rises an elevated plateau of 180 feet in altitude, and stretches off toward Lenox with a rolling surface of lawn, field, and forest. From this crest the local geography of the valley and its surroundings may be studied under the combined charms of grandeur and beauty. The wooded foot hills of the Taconic range slope more or less abruptly toward the lake and rivers, broken by the deep gorge through which the highway runs to West Stockbridge. The curve of the Housatonic may be traced along the meadows, glinting through its fringe of willows and gracefully bending toward Glendale. Rattlesnake Peak—the Deowcook of the Indians—rears its craggy front on the northeast; Wnauticook answers its defiance on the west; while Monument, famed in legend and in song, with its ragged curtain of rock shuts in the southwest prospect, save the blue dome of Mount Washington far beyond. Southeastwardly the hills rise rather sharply to another plateau called Beartown, and in the interval between them and Monument are discernible the dimmer heights which overlook northern Connecticut. A spur of the Beartown Hills projects into the valley to the verge of the river and within half a mile of the village. This has been thrice cleft by some geologic convulsion, the lowest fissure constituting Ice

Digitized

Glen, weird and wild, and one of the "lions" of the varied scenery. The second rise is a notable peak called "Laura's Rest," on which its owner, Hon. D. D. Field, has erected an observatory.

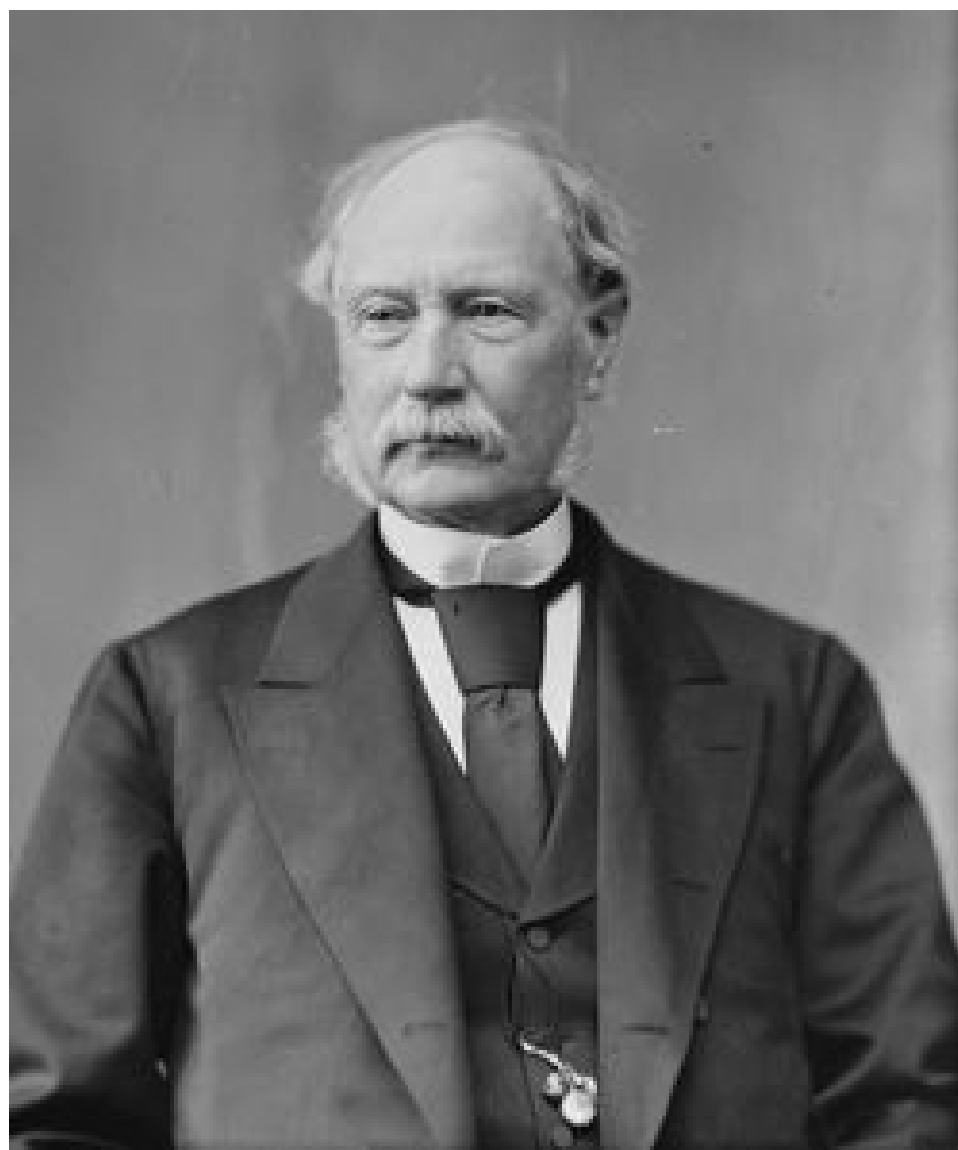

- Leading my first hike to Laura's Tower at age 5
- How I became a stamp collector
- Bluebirds made me an environmentalist
- Fingers stuck in the wringer
- Making gunpowder for rockets
- Swiss Army knife
- 266|
- Overflowing bathtub
- John L. E. Pell
- ice box -- ice from Mohawk Lake
- Belle of the ball (not)
- Baseball & My Father
- Hurricane Carol
- Neckerchiefs and other Norman Rockwell stories
- Thornton Wilder (1897-1975)
- Winston Churchill

Courtesy W. Bousquet





1112



Courtesy W. Bousquet

266

LIFE

FIRST TIME IN COLOR
EIGHT PAGES OF
WORLD'S RAREST STAMPS

STAMP
BY
LIFE

50 CENTS

MAY 3, 1954



The first message took 17 hours to transmit across the Atlantic. It said, “Glory to God in the highest; on earth, peace and good will towards men.” Then Queen Victoria of England and President James Buchanan of the United States exchanged congratulations.



Rev. Adonijah Bidwell (b. 18 Oct 1716)

Adonijah Bidwell (b. 6 Aug 1761)

Barnabas Bidwell (b. 13 March 1796)

Edwin Curtis Bidwell (b. 20 Feb 1821)

Edwin Hugh Bidwell (b. 23 May 1859)

Grace Josephine Bidwell b. (26 July 1891 (Wilcox)

Isabella Ellen Bidwell (b. 24 Feb 1889)

Richard Souder Bidwell (b. 2 Sep 1886) President Cleveland

Graham Davies Wilcox, Jr. (b. 7 April 1916)

Richard Bidwell Wilcox (b. 17 Feb 1949)

554 & 576.

129

My father B.B. and his cousin Edwin Brewer were together in the regiment that went from Western Mass to Boston near the close of the war of 1812-1814.

E. B. once told me that when marching in the ranks thro' the streets of Boston he was hailed from the wayside by an entire stranger and asked if his name was not Brewer. As I recalled the circumstance impressed me as an illustration of heredity, or persistence of type, and I think that was his idea. The Brewer family from which he sprang had been people of Eastern Mass. from almost its earliest settlement, and his grt-grandfather (I think) was the ancestor who migrated from that region to Tyngham more than half a century before.

The same cast of features was marked in his brother the Rev. Josiah, and is still visible Josiah's son, U.S. Supreme Justice David J. Brewer. (577. & 1159.)

Remarkable Women of New England

*Daughters, Sisters, and Mothers
The Nineteenth Century 1791 to 1891*

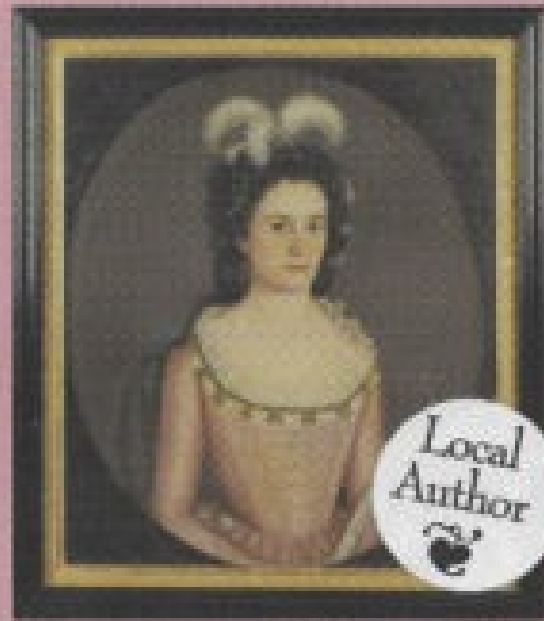

Carole Brown

COMPILED PLAN OF
"Indiantown"
OR
STOCKBRIDGE.

Scale 200 Rods to an inch.

Note:- This plan is approximate only, as the Proprietors records are not clear on many points.

The plan should be used advisedly.

The records recite the existence of a plan but it has not been found. ^{Quinn}

- 142 Jacob Mounaumpetuk
144 Kaukokoht
145 Jacob Cheeksonkum
146 Wautaukaumeet
147 Kwum pashuust
157 Deacon Peter Ahquennaupet
160 Phineas Noss
164 John Williams
167 Rev. Jonathan Edwards
168 Jacob Cheeksonkum
169 Wadchickum
170 Jacob Cheeksonkum
187 do do
19 Jacob Tusnuk
192 J. Mphoson
194 Heirs of John Aphehonnunuwok
198 Quamqueeshuk
202 Cheeksonkum & Nohogohun
210 Selomen Ukquapnuwagunuwuhut
212 Wautaukaumeet
215 Friedrich
219 Hutchinson
220 H. Mouton kawwant
221 Aaron Shagshokhock
225 John
236 Joseph Shauquachthogot
241 Joab Benny

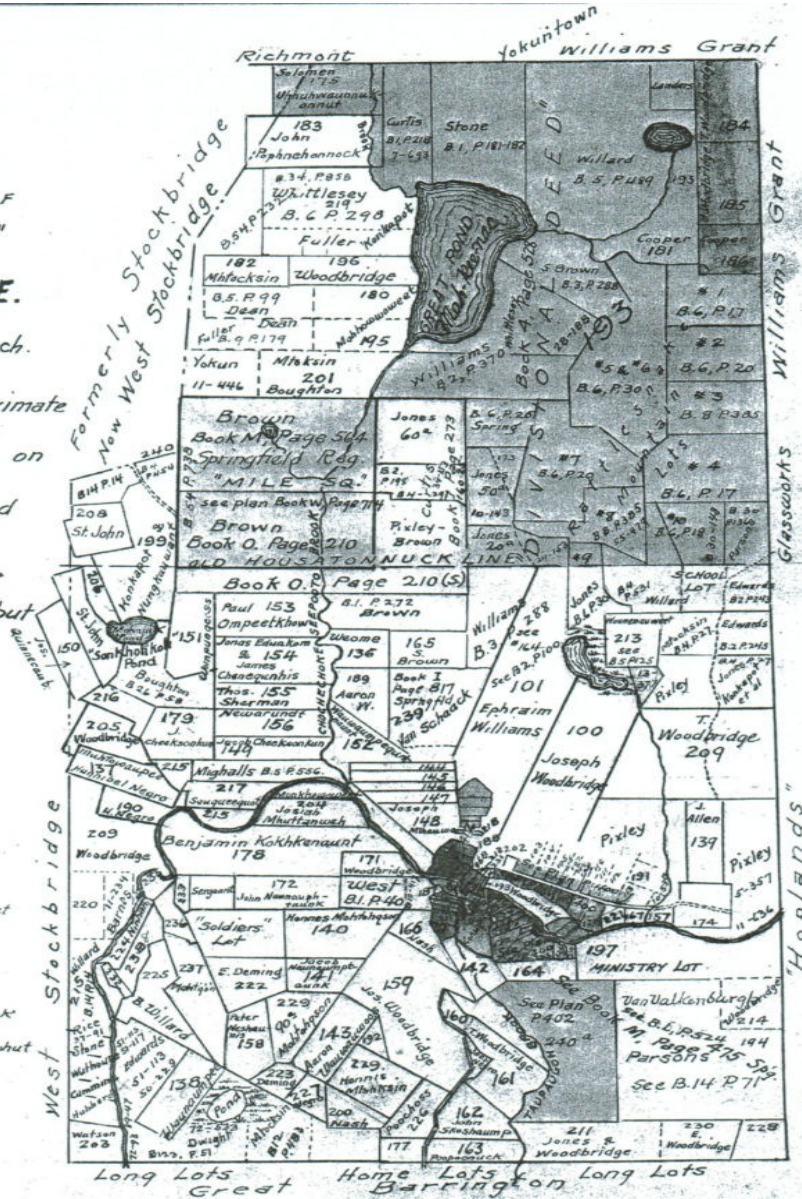

TROOP 59



5TH

NATIONAL JAMBOREE



Laurel Cottage, photo taken from Main Street.







BRIDGE OF ENTRANCE TO ICY GLEN,
STOCKBRIDGE, MASS.



